

2019

RELEASED FOR PUBLICATION

THIS DRAWING IS UNPUBLISHED.

TE Connectivity. All Rights Reserved. © COPYRIGHT 2014

LOC DIST

REVISIONS

P	LTR	DESCRIPTION	DATE	DWN	APVD
	A	NEW RELEASE PER ECO-14-010245	05AUG2014	DM	DM
	A1	REVISED PER PCN E-18-002290	15FEB2018	DD	DM
	A2	REVISED PER PCN E-19-014637	02OCT2019	JA	IG

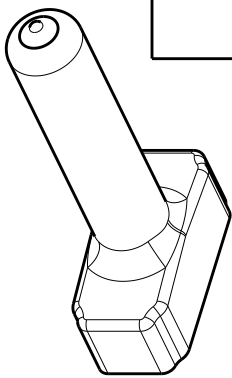

SCALE 3:4

( $\varnothing 10.92$ )  
[.430]

(29.46)  
[1.160]

1.52±0.25  
[.060±.010]  
MEASURED 6.35±0.64  
[.250±.025]  
FROM OPEN END

(37.24)  
[1.466]

(11.71)  
[.461]

(14.94)  
[.588]

69.93±3.81  
[2.753±.150]

- 4 SMALL MATERIAL EXTENSION IS ACCEPTABLE ON THIS END ALL AROUND.
3. THIS ACCESSORY PART IS PROVIDED WITHOUT TYPICAL TRANSPORTATION INDUSTRY PROCESS CONTROL. NO VALIDATION TESTING HAS BEEN PERFORMED. CUSTOMER IS RESPONSIBLE FOR DETERMINING PRODUCT PERFORMANCE AND SUITABILITY FOR APPLICATION.
  2. TEMPERATURE RATING: -29°C TO +100°C [-20°F TO +212°F]
  1. THIS PART IS USED ON DTM06-12SX (X=A,B,C,D KEYS) PLUG WITH ANY MODIFICATION THAT DOES NOT INCLUDE AN END CAP.

TE INTERNAL PN	DEUTSCH PN
DTM12S-BT	DTM12S-BT

DIMENSIONS:  
mm [INCHES]

TOLERANCES UNLESS OTHERWISE SPECIFIED:

0 PLC	±
1 PLC	±
2 PLC	±
3 PLC	±0.63 [.025]
4 PLC	±
ANGLES	±0°30'0"

DWN D.MEYER	07JUL2014
CHK B.MILLIGAN	07JUL2014
APVD D.MEYER	07JUL2014
PRODUCT SPEC	
APPLICATION SPEC	
WEIGHT	6.52g

MATERIAL	PVC	FINISH	GRAY
<b>TE</b> TE Connectivity			
NAME BOOT, PLUG, 12PIN DTM SERIES			
SIZE	CAGE CODE	DRAWING NO	RESTRICTED TO
A4	4AFU8	©-DTM12S-BT	-



CUSTOMER DRAWING	SCALE 5:4	SHEET 1 OF 1	REV A2
------------------	-----------	--------------	--------